

# Technical data sheet

## PYROLINE® Con S PLC fire protection duct EI90



Item number: 7217874



Fire protection duct made of water and frost-resistant fibreglass lightweight concrete of material class A1 according to EN 13501-1 for fireproof routing of cables in escape and rescue routes. EI60 classification as installation duct according to EN 13501-2 on the basis of tests according to EN 1366-5. When there is an internal fire load (cable fire), the duct prevents the spread of fire from one fire section to another.

Mounting of the duct on wall brackets or as ceiling mounting with suspended supports and brackets or on a U transverse profile suspended with threaded rods. Mounted connectors ensure quick mounting in situ, whilst loosely placed covers ensure quick inspection and reassignment.

Including connection screws and sealing strips.

Including connection screws and sealing strips.



Fibreglass lightweight concrete

### Master data

|                     |                                 |
|---------------------|---------------------------------|
| Item number         | 7217874                         |
| Type                | PLCS D091220                    |
| Description 1       | Fire protection duct EI90       |
| Description 2       | Suspended mounting              |
| Manufacturer        | OBO                             |
| Dimension           | 1000x200x120                    |
| Colour              | Grey                            |
| Material            | Fibreglass lightweight concrete |
| Smallest sales unit | 1                               |
| Unit of quantity    | Metre                           |
| Weight              | 3780 kg                         |
| Weight unit         | kg/100 m                        |

# Technical data sheet

## PYROLINE® Con S PLC fire protection duct EI90



Item number: 7217874

### Dimensions

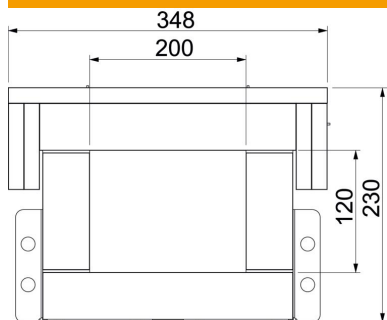

|             |          |
|-------------|----------|
| Length      | 1,000 mm |
| Dimension B | 348 mm   |
| Dimension b | 200 mm   |
| Dimension h | 120 mm   |
| Dimension H | 230 mm   |

### Technical data

|                                       |                                  |
|---------------------------------------|----------------------------------|
| Number of flammable sides             | 4                                |
| Cover fastening                       | Loose                            |
| Classification EI – installation duct | 90                               |
| With perforation                      | no                               |
| Jacketing                             | Without                          |
| Material of the insulation            | Glass-fibre lightweight concrete |